

The Solway

3-bedroom home

The Solway is an impressive 3-bedroom home with plenty of living space spread across 3 perfectly laid-out floors. On the ground floor you'll find a spacious lounge and a separate open plan kitchen and dining area where you can open up the French doors onto the garden. Up the stairs to the first floor are bedrooms 2 and 3 and a large family bathroom with shower and bathtub. The master bedroom has the prime space on the second floor and features a walk-in wardrobe and en-suite shower room.



Features

- Open plan kitchen and dining area with French doors opening onto turfed garden
- Spacious separate lounge
- Toilet on the ground floor
- Family bathroom with shower and bathtub on the first floor
- Master en-suite shower room on the second floor
- Stainless steel integrated double oven, microwave, hob and extractor fan
- Walk-in wardrobe for master bedroom
- Built-in wardrobe in second bedroom

Room Dimensions

Ground Floor

KITCHEN/DINER	Arrow A 3603	11'-9"
	Arrow B 4601	15'-1"
	Arrow C 3797	12'-5"
	Arrow D 2193	7'-2"
CLOAK	855 x 1877	2'-9" x 6'-1"
LOUNGE	Arrow A 3603	11'-9"
	Arrow B 2962	9'-8"
	Arrow C 4800	15'-9"
	Arrow D 3543	11'-7"

First Floor

BATHROOM	Arrow A 2503	8'-2"
	Arrow B 1850	6'-0"
	Arrow C 1794	5'-10"
	Arrow D 2540	8'-4"
BEDROOM 2	Arrow A 2608	8'-6"
	Arrow B 3958	12' 11"
	Arrow C 3015	9'-10"
	Arrow D 2269	7'-5"
WARDROBE	500 x 2269	1'7" x 7'5"
BEDROOM 3	2503 max x 3678 max	8'-2" x 12'-0"
	1513 min x 2674 min	4'-11" x 8'-9"

Second Floor

MASTER BEDROOM	Arrow A 3534	11'-7"
	Arrow B 4600	15'-1"
	Arrow C 4845	15'-10"
	Arrow D 3268	10'-8"
EN-SUITE	2095 x 1861	6'-10" x 6'-1"
WARDROBE	2364 x 1861	7'-9" x 6'-1"

Ground Floor

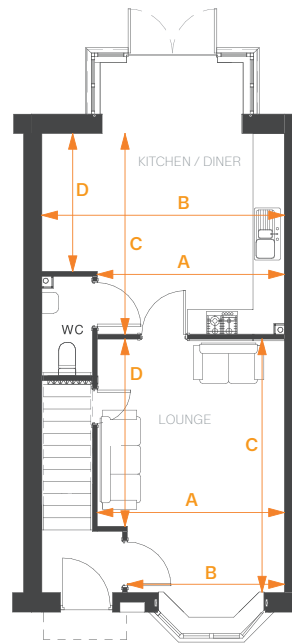

First Floor

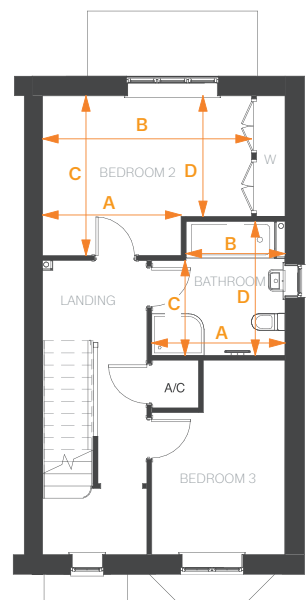

Second Floor

