

The Douglas

3-bedroom home

As you walk through the front door and into the hallway of The Douglas, you'll soon discover the unique shape of this attractive home offers lots of room, with an open-plan kitchen and dining area and good-sized lounge providing plenty of living space. French doors in the dining area open onto the rear garden and create a lovely light and bright space for eating inside or BBQing outside.

Upstairs the principle bedroom has an en-suite shower room and built-in wardrobe, so you can treat yourself to a little luxury, while the other two bedrooms share a generous family bathroom complete with bathtub. If you have a bedroom going spare and work from home, you can easily turn one into the ideal office space.



313221.HABM_0101



All drawings, plans, and images are for illustrative purposes only. Room measurements are approximate. Finishes and layouts may vary and, during the construction process, plans might be subject to change. For more information, speak to your sales consultant.

Features

- Open-plan kitchen and dining area looking out on rear garden
- Spacious separate lounge with window to front garden
- Downstairs cloakroom, family bathroom, and principle bedroom en-suite
- High quality Smeg kitchen appliances
- Built-in wardrobe in principle bedroom
- HIVE smart home system

Room Dimensions

Ground Floor

LOUNGE

Arrow A	3704mm	12'1"
Arrow B	4744mm	15'6"
Arrow C	3491mm	11'5"

KITCHEN/DINING

Arrow D	3615mm	11'10"
Arrow E	2265mm	7'5"
Arrow F	2343mm	7'8"

CLOAKROOM

925mm x 1625mm	3'0" x 5'3"
----------------	-------------

First Floor

BEDROOM 1

Arrow A	2877mm	9'5"
Arrow B	3713mm	12'2"

EN-SUITE

2088mm x 1845mm	6'10" x 6'0"
-----------------	--------------

BEDROOM 2

2795mm x 3511mm	9'2" x 11'6"
-----------------	--------------

BEDROOM 3

Arrow C	1397mm	4'7"
Arrow D	2602mm	8'6"
Arrow E	2381mm	7'9"

BATHROOM

2125mm x 1922mm	6'11" x 6'3"
-----------------	--------------

Ground Floor

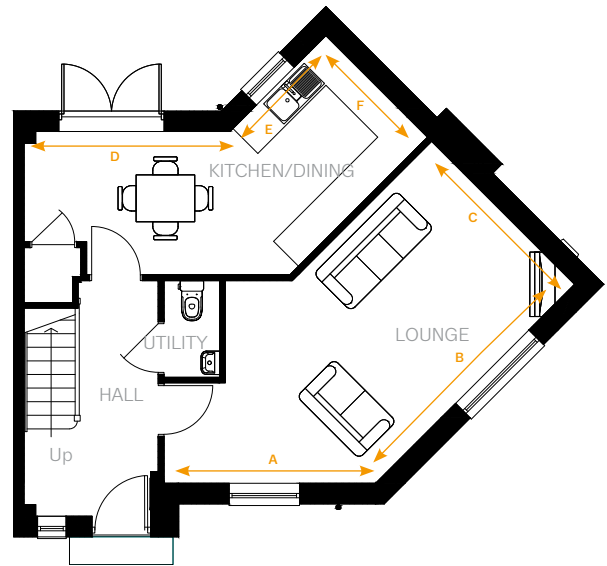

First Floor

