

# The Wye

---

## 3-bedroom detached home

The Wye town house has a wonderfully classic look. Inside you have a spacious Kitchen, which looks out onto the garden through French doors and has plenty of room for dining or even a desk if you work from home.

It shares the ground floor with a modern lounge, hallway, cloakroom and storage space.

On the upper floor you'll find three bedrooms and a family bathroom; one of the larger rooms has a view of the back garden, making it a perfect choice for a principle bedroom.



# Features

- Large Kitchen and dining area looking out on rear garden
- Separate modern lounge
- Cloakroom and family bathroom with bathtub
- Private garden reached through French doors
- High quality Smeg kitchen appliances
- Built-in wardrobes
- HIVE smart home system

# Room Dimensions

## Ground Floor

### LOUNGE

ARROW A	3848	12'7"
ARROW B	2950	9'8"
ARROW C	5140	16'10"
ARROW D	3235	10'7"

KITCHEN/DINING	4950 x 2900	16'2" x 9'6"
----------------	-------------	--------------

CLOAKS	990 x 1620	3'2" x 5'3"
--------	------------	-------------

## First Floor

### BEDROOM 1

ARROW E	3204	10'6"
ARROW F	4950	16'2"
ARROW G	2869	9'4"
ARROW H	3964	13'0"
ARROW J	1262	4'1"

### BEDROOM 2

ARROW K	2335	7'7"
ARROW L	2883	9'5"
ARROW M	2937	9'7"
ARROW N	1156	3'9"

### BEDROOM 3

ARROW P	2502	8'2"
ARROW R	1953	6'4"
ARROW S	1687	5'6"
ARROW T	2937	9'7"

BATHROOM	1860 x 2145	6'1" x 7'0"
----------	-------------	-------------

Ground Floor

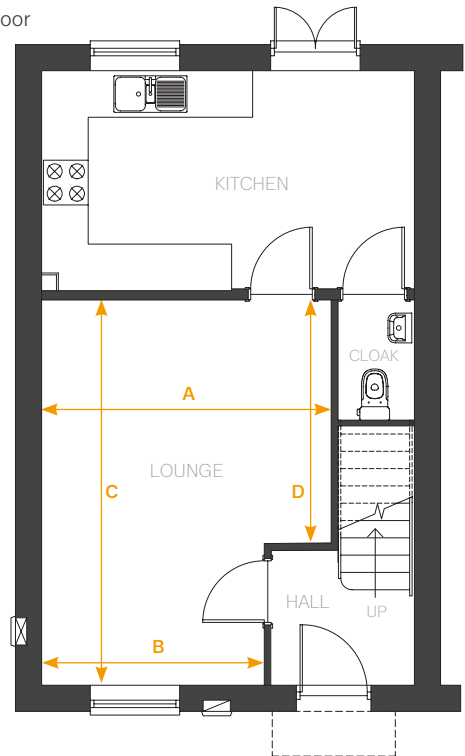

First Floor

